



# VIKAS INDUSTRIES

A GOVT. OF INDIA RECOGNISED STAR EXPORT HOUSE



AN ISO 9001: 2015 CERTIFIED COMPANY  
A UL LISTED COMPANY

## CLEVIS HANGER

**CONSTRUCTION :** CLEVIS HANGER IS A COMBINATION OF TWO CLEVISES U & V ATTACHED TOGETHER WITH THE HELP OF CROSS BOLT AND A NUT.

**APPLICATION :** IT IS USED FOR SUSPENSION OF NON-INSULATED STATIONERY PIPELINES WITH A GENEROUS RANGE OF 20 TO 150MM. CLEVIS HANGERS PROVIDES FLEXIBILITY IN ACCOMMODATING DIFFERENT PIPE HEIGHT AND ALIGNMENT REQUIREMENTS. CLEVIS HANGER ALLOWS FOR PRECISE VERTICLE ADJUSTMENT OF PIPES EVEN AFTER INSTALLATION. THIS FEATURE ENABLES FINE TUNING OF THE PIPE'S POSITION TO ENSURE OPTIMAL ALIGNMENT AND SUPPORT.

**APPROVALS :** UNDERWRITERS LABORATORIES U.L. , U.L.C. LISTED (SIZE: 1" to 8")

**COMPLIANCE :** ANSI / CAN/UL 203:2020 (REF. ASTM A653M, NFPA13, UL 2043)

**MATERIAL :** MILD STEEL

**FINISH :** ELECTRO GALVANIZED AS PER ASTM B 633.

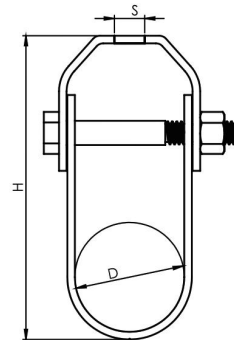
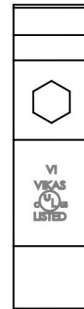
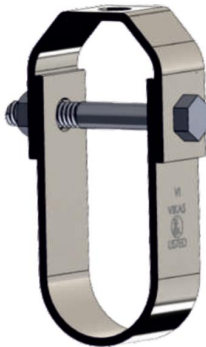

### CLEVIS HANGERS

Article No.	Nominal Pipe Size (Inch)	Diameter (D) MM	Hanger Rod Size (MM) (R) MM	Height (H)	Top Hole S (MM)	Cross Bolt	Max Load (Kg.)
VICH-01	1"	34	M10	76	11	M8	350
VICH-02	1-1/4"	42	M10	87	11	M8	350
VICH-03	1-1/2"	48	M10	97	11	M8	350
VICH-04	2"	60	M10	114	11	M8	350
VICH-05	2-1/2"	75	M12	142	13	M10	780
VICH-06	3"	89	M12	165	13	M10	780
VICH-07	3-1/2"	102	M12	190	13	M10	780
VICH-08	4"	115	M12	202	13	M10	780
VICH-09	5"	142	M12/M16	231	13/17	M12	1300
VICH-10	6"	168	M12/M16	278	13/17	M12	1300
VICH-11	8"	219	M12/M16	336	13/17	M12	2100

F-76-77, Phase-VII, Focal Point, Ludhiana-141010 (Pb.) INDIA

Works : Focal Point Extn., Dhandari Khurd, Ludhiana.

Mobile: +91-98140-03794, +91-98554-29173, +91-98554-29174

E-mail: export@vikasindustriesindia.com, info@vikasindustriesindia.com

www.vikasindustries.net