



VIKAS INDUSTRIES

A GOVT. OF INDIA RECOGNISED STAR EXPORT HOUSE



AN ISO 9001: 2015 CERTIFIED COMPANY

A UL LISTED COMPANY

COUPLER

ASME B16.11-2016 (Revision of ASME B16.11-2011)

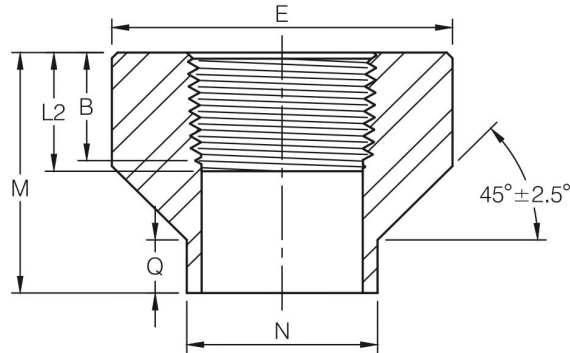

Dimensions are in millimeters.

Threaded							
DN	Nom. Pipe Size	Length of Thread (Min)		N	Q	M	E
		B(*)	L2(*)				

3000Lb

8	1/4	8.1	10.2	17.5	9.5	30.2	23.8
10	3/8	9.1	10.4	20.7	9.5	30.2	27.0
15	1/2	10.9	13.6	23.8	9.5	33.4	33.4
20	3/4	12.7	13.9	27.0	9.5	34.9	38.1
25	1	14.7	17.3	33.4	9.5	42.9	46.1
32	1-1/4	17.0	18.0	42.9	9.5	47.6	55.6
40	1-1/2	17.8	18.4	49.2	9.5	50.8	63.5
50	2	19.0	19.2	61.9	9.5	57.2	79.4
65	2-1/2	23.6	28.9	73.0	9.5	63.5	92.1
80	3	25.9	30.5	88.9	9.5	69.9	111.1
100	4	27.7	33.0	114.3	9.5	76.2	141.3

6000Lb

8	1/4	8.1	10.2	17.5	9.5	30.2	25.4
10	3/8	9.1	10.4	20.7	9.5	30.2	31.8
15	1/2	10.9	13.6	23.8	9.5	33.4	38.1
20	3/4	12.7	13.9	27.0	9.5	34.9	44.5
25	1	14.7	17.3	33.4	9.5	42.9	57.2
32	1-1/4	17.0	18.0	42.9	9.5	47.6	63.5
40	1-1/2	17.8	18.4	49.2	9.5	50.8	76.2
50	2	19.0	19.2	61.9	9.5	57.2	92.1
65	2-1/2	23.6	28.9	73.0	9.5	63.5	108.0
80	3	25.9	30.5	88.9	9.5	69.9	127.0
100	4	27.7	33.0	114.3	9.5	76.2	158.8

DIMENSIONAL TOLERANCE OF ASME B16.11

Unit: mm

Item	N	Q	M	E
1/4"~1-1/2"	+1.5/-0.0	±0.8	+0.8/-0.0	+1.5/-0.0
2"~4"	+1.5/-0.0	±0.8	+1.5/-0.0	+1.5/-0.0

(*) Dimension B is minimum length of perfect thread. The length of useful thread (B plus threads with fully formed roots and flat crests) shall not be less than L2 (effective length of external thread) required by American National standard for pipe threads (ANSI/ASME B1.20.1).